



## USER GUIDE INSTRUCTIONS

FIND OUR INSTRUCTIONS VIDEOS AND MORE ON OUR WEBSITE;  
[JAYMAREXPERIENCE.COM](http://JAYMAREXPERIENCE.COM)

### CONGRATULATIONS!

**You have just received your Jaymar Experience recliner seats!**

Please read all instructions carefully before starting the assembly.

## ASSEMBLY OF YOUR RECLINER SEAT

### GET READY

Unpack the box - Remove all packaging from your seat.

You should have in your Jaymar Experience box: 1 seat base, 1 seat back and a transformer with an electric outlet.



No tools required for assembly .

## STEP 1

Ensure that the back clips are properly aligned with the anchor of the seat base on both sides.



## STEP 2

Slide the anchors into the clips and move the back slightly from left to right to lower it and engage it.



## STEP 3

To ensure that your furniture is delivered without damage, Jaymar positions the anchor brackets on the inside of your furniture.

1. Lay your furniture on its side so that you have access to the underneath of it and find the brackets.
2. Unscrew the butterfly bolt and remove the bracket.
3. Flip the bracket over so that it is on the outside of the furniture, then screw the butterfly bolt back on.
4. Lift your other furniture and pass it over the brackets.

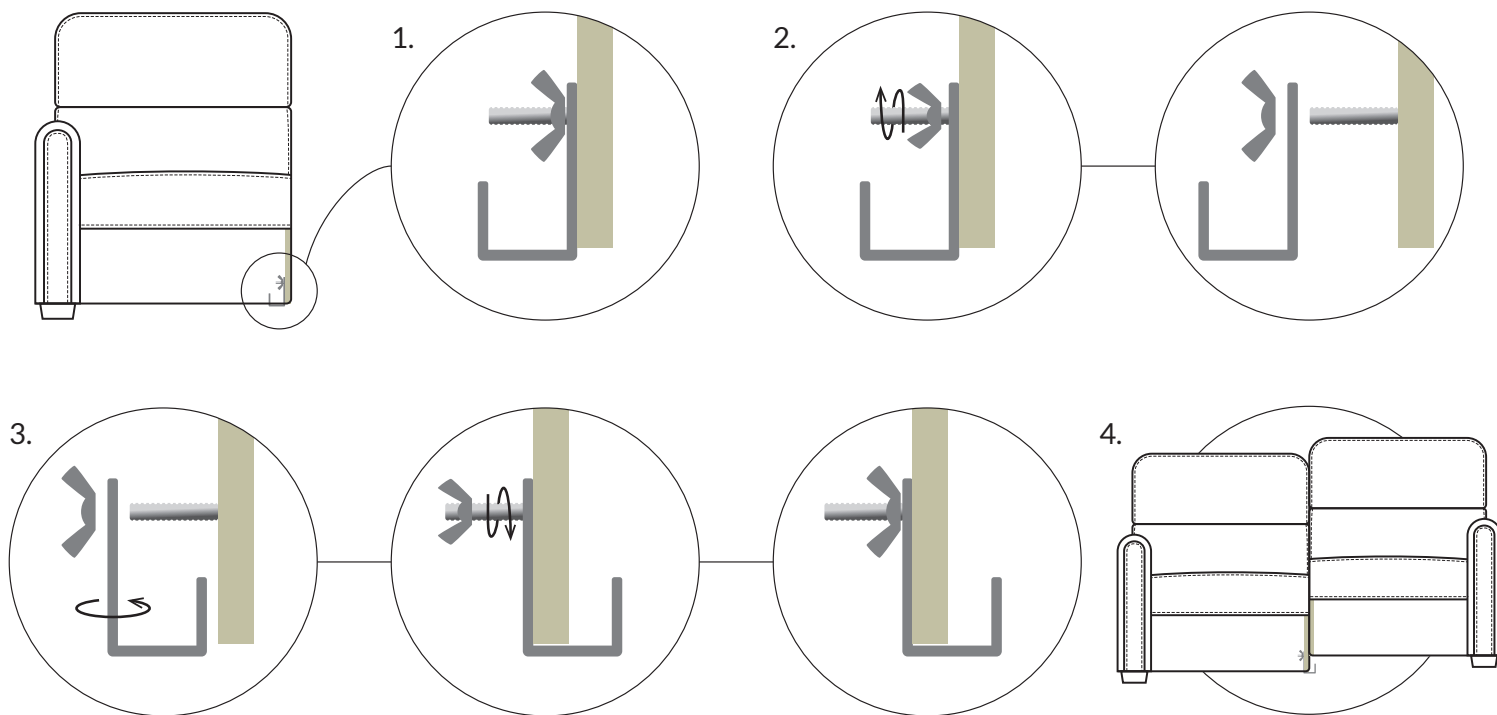

**ATTENTION!** Make sure the furniture is well inserted in brackets.

## ANTI TILT ASSEMBLY

### ONLY FOR ARMLESS CHAIR

After installing the brackets, rotate the black metal bar located in the back to prevent tipping while in use.

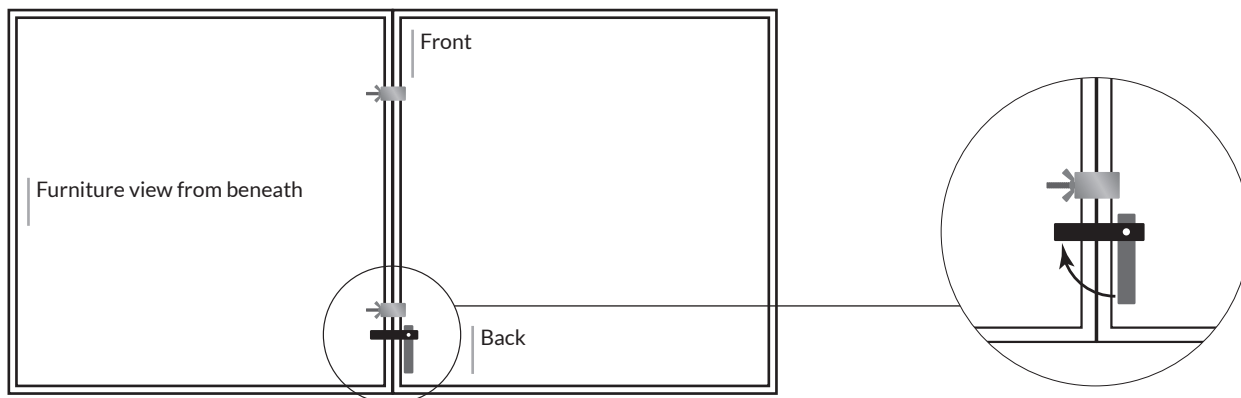

## STEP 4

### activate the electrical mechanism

#### IMPORTANT!

Before you activate the electrical mechanism, lay your furniture on its side and cut the straps that hold the transformer. Then, remove it, **put it next to your chair,\*** on the floor, and plug it into an electrical outlet.

\*The manufacturer will not be held responsible if any accident occurs because the transformer has not been removed from underneath the furniture.

#### SINGLE RECLINER SEAT

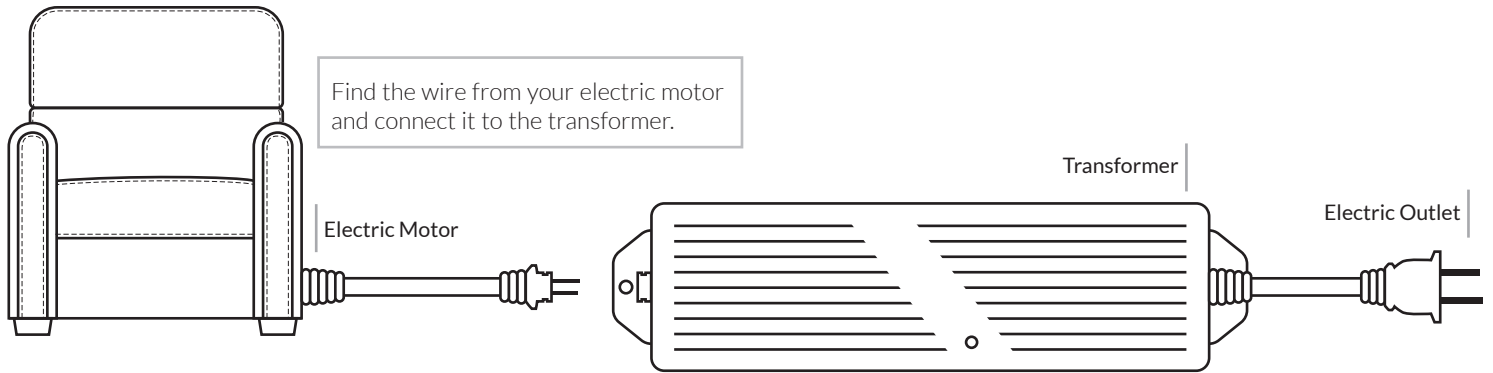

#### MULTIPLE SEATS

##### "Y" SPLITTER

If you have two electric motors, connect both wires to the "Y" splitter, then connect the "Y" splitter to the transformer.

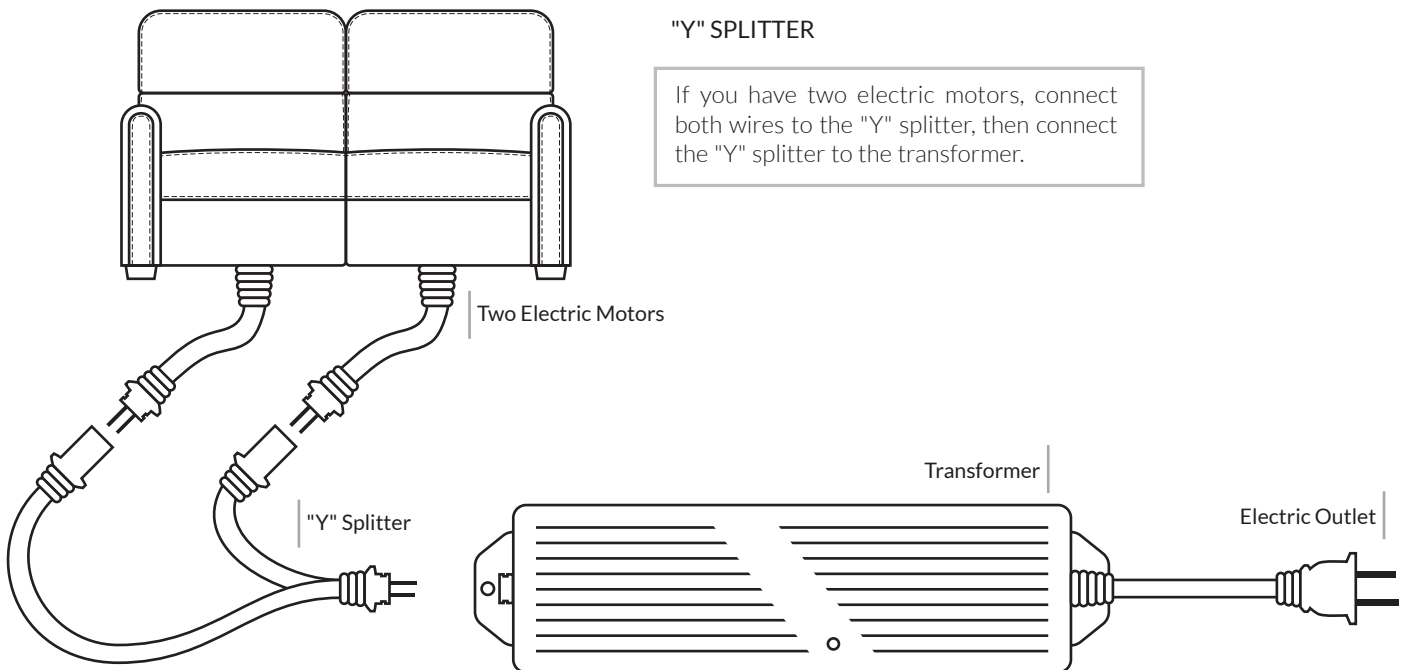

#### WARNING

Do not immerse in water or other liquids at any time. To clean, wipe with a damp cloth. Do not store or operate the device in a high humidity area.

Do not store or operate the device in an environment that is subject to explosion hazards or open fire.

Do not open or tamper with the device. There are no user serviceable parts in these units. Opening the device will immediately void the warranty.

Ensure correct polarity is used when connecting motors, etc. This is normally governed by the original plugs and connectors. Do not short circuit.

The device should be recharged within the norm temperatures of 0°C to 40°C (32°F to 104°F).

## TIPS TO INSTALL YOUR RECLINER SEAT IN YOUR ROOM

Leave a clearance of 4" between each **D-BOX** chair to not block the range of motion.  
If the chair is near a wall, allow 6" of clearance.

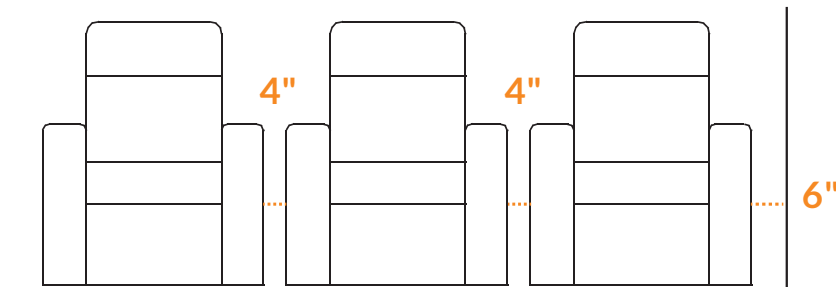

Keep 6,5" of wall clearance behind your seat and 20" in front.

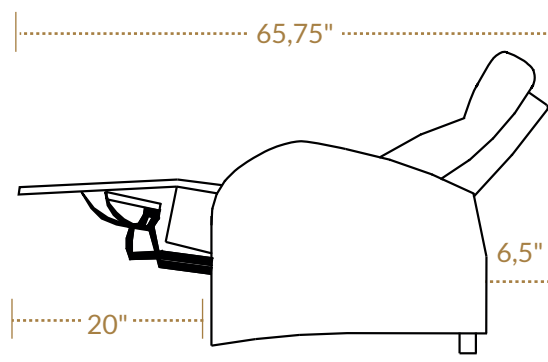

## MULTIPLE ROWS INSTALLATION

If you have many rows, we recommend having the 20" space for the footrest

+

wall clearance distance of 6.5"

+

12" not to touch the front headrest when you lay down.

